



From the Heart



Newsletter No. 03

14th February, 2024

COMING UP AT OLSH...

FEBRUARY 2024

Thu 21st	PSG's
Thu 22nd	Beginning of year Mass (6pm)
Mon 26th	School Cluster Swimming Carnival

MARCH 2024

Wed 6th	Yr 5/6 Puberty Night (7pm—8pm)
Friday 8th	Spirituality Day—Pupil Free Day
Mon 11th	Labour Day Public Holiday
Tue 12th	School Photos
Wed 13th	NAPLAN Writing Testing begins (year 3 & 5's)
Sat 16th	Elmore Tractor Pull
Tue 19th	NAPLAN Reading Testing begins (year 3 & 5's)
Wed 20th	Lenten Mass NAPLAN Language Conventions NAPLAN numeracy
Thu 21st	Harmony Day
Fri 22nd	Ride to School Day Open Classroom Day (2:30pm—3:30pm)
Mon 25th	NAPLAN catch up session
Thu 28th	Last Day of Term
Fri 29th	Good Friday
Sun 31st	Easter Sunday

APRIL 2024

Mon 1st	Easter Monday
Mon 15th	Term 2 Begins
Thu 25th	ANZAC Day Public Holiday

From the Principal...

February 14th,

Dear Families,

Yesterday we had a very unusual start to the day, with our Shrove Tuesday pancake making initially put on hold due to the total fire ban, however, a few staff and parents jumped in and came up with a Plan B, where we used electric frying pans and cooked up the pancakes in the Chevi Centre!! So the children still all received a nice serving of pancakes, but we will do the Year 6 'cook off' *at the end of Lent. Thanks so much to everyone who was able to help us out with this!*

Lent

Lent is a very special time on our Catholic calendar, as we remember the sacrifice that Jesus made when he fasted for 40 days. The idea is to reflect on Jesus' sacrifice, his victory over temptation, and the spiritual discipline involved in following his example. We ask our learners to think about the ways that they can do acts of kindness to others throughout this Lenten period, whilst also looking at ways they can reduce those things in their lives that may be a little excessive - like screen time, sweets, soft drinks etc. As adults we should also feel free to join them in committing to these Lenten actions.

Beginning Of Year Mass - February 22nd at 6.00pm

Next Thursday, February 22nd, we will be holding our Beginning of Year Mass at the OLSH Church beginning at 6.00pm. We encourage all families and friends to come along to this special opening to our school year. Everyone is then invited to come back to school for a BYO picnic dinner.

Staff Spirituality Day - March 8th - Pupil Free Day

On Friday March 8th is a pupil free day, as, our staff will be joining other staff members from our Northern Plains Cluster (Kerang, Cohuna, Pyramid Hill, Echuca, Heathcote, Inglewood and Rochester) for a 'Spirituality Day' to be hosted at St. Mary's Primary School in Echuca.

Playground Development

For the past couple of years we have been looking at the idea of updating the play equipment at the back of the school, often referred to as the senior play equipment. Rather than just replace like for like though, we are investigating the idea of developing this whole back space so that it becomes more of an integrated, natural play space area, but still with play equipment within it. A company called Sentient Design have put together a plan for us to consider, which I am attaching as part of this newsletter. Please take the time to have a look and see what you think and send through any thoughts that you might have.

Our Lady of the Sacred Heart School promotes the safety, wellbeing and inclusion of all children.

W: olshelmore.catholic.edu.au PH: 5432 6254 E: principal@olshelmore.catholic.edu.au

Caritas Fundraising

Throughout Lent, each of our classrooms will be holding special events to help raise funds for Caritas. Caritas supports disadvantaged youth across the world and is a Catholic organization. Fundraising begins next week with the Grade 3/4 class selling Zooper Doopers each day at second break for 50c. Please see other initiatives in the upcoming weeks.

Craig

School News

LEARNERS OF THE WEEK



WEEK 8: Congratulations to Zayde, Reece, Roy, Jimmy, Ivy, Dawn, Amelia and Charlie for being named our Learners of the Week!

This is the artwork from former student, Ruby Dankers, being used to advertise Sandhurst Switches off for 2024.

On Friday the 22nd of March, OLSH will be joining the initiative and switching off our lights for part of the day.

SANDHURST SWITCHES OFF!

FRIDAY 22 MARCH 2024

Join schools around the diocese in turning off lights for one hour!

In Sandhurst, we invite you to participate in Sandhurst Switches Off.

All Catholic schools and Catholic Education Offices will be encouraged to turn off their lights and any other electronic devices for part of the day or a whole day.

This action is symbolic of our commitment to the preservation of God's fragile creation. It is also symbolic of our solidarity with those who are suffering due to climate change. Let us reimagine our partnership with all of creation.

'If we approach nature and the environment without this openness to awe and wonder, if we no longer speak the language of fraternity and beauty in our relationship with the world, our attitude will be that of masters, consumers, ruthless exploiters, unable to set limits on their immediate needs.'

Laudate Si, Pope Francis, p. 17

BEHIND THE SCENES

Artwork: 2023 MacKillop Art Exhibition Entry, Climate Change, Ruby Dankers, Yr 6, Our Lady of the Sacred Heart PS, Elmore - 2023 Winner Spiritual Art Award (Yrs 5-6)

When Valentine's Day falls on Ash Wednesday



ASHES ARE ALSO PLACES WHERE POSSIBILITY CAN
ARISE. FROM THE ASH OF BUSHFIRES GRASS AND
PLANTS SPRING GREEN. ON A BOMB-LEVELLED CITY A
BETTER PLACE FOR ITS CITIZENS CAN BE BUILT. OUT OF
A SCORCHED RELATIONSHIP WISDOM AND
COMPASSION CAN GROW. WHEN WE ATTEND TO THE
ASHES OF OUR LIVES AND OUR WORLD, WE CAN
RECOGNISE THEIR CAUSES AND CHANGE OUR WAY OF
LIFE.



ASH WEDNESDAY

Lent
**BEGINS
TODAY.**

LET US ASK FOR THE
GRACE TO BE MORE
ATTUNED TO OUR
DEEP DOWN HUNGER
AND THIRST FOR GOD'S
PRESENCE IN OUR
DAYS

Coming up at OLSH



ASSEMBLY

CELEBRATING LEARNING

SINGING PRAYER



FRIDAY AFTERNOONS
3:10PM
In the Junior Room



ZOOOPER DOOPER



RAISING MONEY FOR

50c each

 **Caritas**
AUSTRALIA

Pray Fast Give



Join Us

Beginning of the Year Mass

6 pm

Thursday 22nd February

FREE PARENT WEBINAR

How to support positive peer relationships among young people in online spaces.

AIFS Peer Relationships online - Parent Webinar

Wednesday 21 February 2024

1.00 pm - 2.00 pm

This free parent webinar will explore ways to support young people to develop positive peer relationships in online spaces to promote well-being.

This webinar will help you:

- understand the similarities and differences between online and offline peer relationships and interactions
- understand the benefits of online peer relationships for young people and some of the challenges they experience while navigating them, including their impacts on mental health and wellbeing
- develop insight into how to support young people to develop positive peer relationships in online spaces and how families can encourage these positive relationships.

<https://register.gotowebinar.com/register/3124230841082619>
227

OLSH 2024 CARITAS FUNDRAISING

EASTER RAFFLE

TICKETS WILL BE SENT HOME IN WEEK 5

RAFFLE DRAWN AT OUR OPEN AFTERNOON/ ASSEMBLY
FRIDAY 22ND MARCH.

**Casual Clothes Day on
Thursday March 14th**
with an Easter Item donation.
Donations will be used to
make up hampers.



**LENT
2024
GRADE FIVE**



Clean out those cupboards and bring your best
quality clothing to school!
Swap it out for something fresh and new while
helping those in need.
Plus, with just a gold coin donation to Caritas, you're
making a big difference in the world.

**LET'S TURN FASHION INTO
COMPASSION
TOGETHER!**



Elmore
Food Share

**Foodshare
Term 1
2024**

**CANNED GOODS
& BREAKFAST
CEREALS**



Proposed Playground Upgrade

PLAN VIEW

Trees shown at mature size



PLAY PROVISION

Active play opportunities are provided by the range of proprietary equipment housed under the fixed shade structure. The range of equipment is designed to include climbing, traversing and balancing activities to build strength and coordination. While compliant to Australian Standards for play grounds, the equipment is proposed to be natural in appearance and fit into the yard environment.

Cognitive play opportunities are provided by many different elements of the concept. The Permaculture Garden will stimulate children to consider what plants need and by extension human impact on ecosystems and biodiversity. Adding a water tap to the sand pit will extend the sand play, stimulating imagination and creativity. The Bush Cubby area provides prompts to encourage children to develop their own ideas about constructing shelters by providing them with loose materials to manipulate.

Social play is encouraged in many different ways. The prayer circle provides a smaller space for private reflection or prayer. The proprietary equipment is set up to allow for larger groups of students, and to encourage races and games. The Permaculture Garden can be a space for one or more children with a number of different activities. The sand pit with water play encourages collaboration to share the water resource.

Client: Our Lady of the Sacred Heart Elmore
Project: Rear Play Yard Landscape Plan
Drawing Title & Version: Preliminary Concept: Plan
Date:

Sentient Design
41 Wooling Road
New Gabbane VIC 3438
www.sentientdesign.com.au
0457 492 274

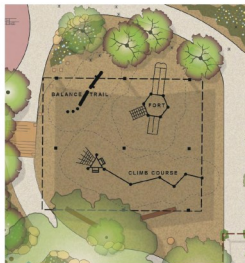

ACTIVE PLAY EQUIPMENT
ALTERNATIVE 1

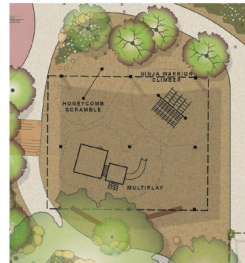

ACTIVE PLAY EQUIPMENT
ALTERNATIVE 2



ACTIVE PLAY EQUIPMENT
ALTERNATIVE 3



SECTION
LOOKING TO THE NW

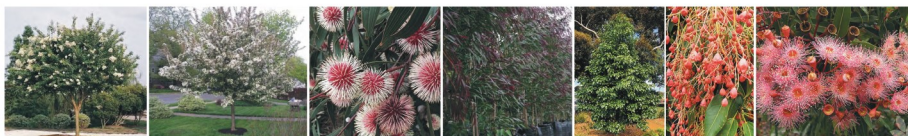

<i>Lagerströmia indica</i> 'Natchez' Cape Myrtle 7m H x 6m W Very high medium deciduous tree with attractive foliage, sprays of white flowers over summer and autumn bark	<i>Mulca 'Sugar Tyme'</i> Cush Apple 6m H x 5m W Drought tolerant small deciduous tree with spring blossom, attractive foliage and small apples held on branches through summer and autumn	<i>Hakea laurata</i> Procumbens Hakea 5m H x 4m W Tough native with long leathery leaves and spectacular bell-like flowers	<i>Argentea Renssela 'Bongardi'</i> Bongardi Willow Pepperberry 5m H x 5m W Small native tree with weeping habit and distinct bongardi coloured foliage	<i>Baccharis repens</i> x <i>acutifolia</i> 'Bella Pink' Bella Pink Baccharis 8m H x 4m W Compact gnarled shade tree with about trunk, rich green leaves and stamens of salmon coloured flowers	<i>Corymbia ficifolia</i> 'Summer Beauty' Dwarf Flowering Gum 6m H x 5m W Small native tree with stunning floral display
--	---	---	--	--	---

PROPOSED TREE SPECIES

Client: Our Lady of the Sacred Heart Elmore
Project: Rear Play Yard Landscape Plan
Drawing Title & Version: Preliminary Concept: Section & Equipment Alternatives
Date: 10 January 2024

Sentient Design
41 Wooling Road
New Gabbane VIC 3438
www.sentientdesign.com.au
0457 492 274

Community News



JOIN THE FUN!

Register to the 2024 Auskick Season for the opportunity to be involved in a clinic with North Melbourne or Carlton as part of the AFL Community Camps in Bendigo! Don't miss out on this fantastic opportunity!

Find your closest centre & register!



Note: clinics occurring mid Feb

HUNTLY FAMILY FUN DAY

Proudly sponsored by Agnico Eagle Fosterville

FREE ENTRY	SUNDAY FEB 25, 2024	10AM TO 1PM
-------------------	--------------------------------	------------------------

FREE ACTIVITIES:
 THE ZONE JUMPING CASTLE AND INFLATABLE WATER SLIDE
 WATER FUN WITH HUNTLY CFA • ART AND CRAFT
 SPORTING ACTIVITIES • FACE PAINTING • FREE GIVEAWAYS!
 RENEGADES FAN VAN - INFLATABLE CATCH MAT

FOOD/DRINKS:
 BBQ (MEAT AND VEGETARIAN OPTIONS) AND DRINKS
 - ALL \$2 EACH • FREE FRESH FRUIT • COLIBAN WATER
 REFILL UNIT (BYO DRINK BOTTLE)

**STRAUCH RESERVE
14 GUNGURRU ROAD, HUNTLY**

Don't forget a towel!
Limited shade - bring along your hat and chair.

RUNNYMEDE JFC REGISTRATION NIGHT

Wednesday 21st February
 Colbinabbin Recreation Reserve
 5.00pm
 U10's & U12's
 Light training & BBQ
 New & old players/families encouraged to come along
 Contact Craig 0428694648 or Tymika 0434100521 if you are keen to play but can't make it on the night

ROCHESTER U12'S GIRLS FOOTBALL

ROCHESTER IS STARTING AN U12 GIRLS FOOTY TEAM COACHED BY THE NANNEELLA PRINCIPAL, TOM. THEY WILL BE PLAYING IN THE BENDIGO COMPETITION WHICH WILL BE ON FRIDAY NIGHTS.

IF INTERESTED PLEASE CONTACT
 SARAH MANGAN: 54841072



61ST ANNUAL

ELMORE FIELD DAYS

OCT 1, 2 & 3 2024

@ELMORE
 FIELDDDAYS

ElmoreEventsCentre

Elmore Equestrian Park

